



**REDUCE THE RISK OF SERIOUS INJURY  
WITH THE AWARD WINNING  
BLADESTOP BANDSAW**



- Increases the safety in your production
- Reduces the risk of serious injury
- Is a HIGH-END bandsaw for HIGH-END products
- Quality, Hygiene and Safety
- Unique Body-Sensing technology in combination with GloveCheck™
- Has the fastest stopping Bandsaw on the market
- Over 1500 units supplied to over 30 countries



BladeStop was developed by Scott  
in collaboration with MLA and AMPC.

**BladeStop.com**  
bladestop@scottautomation.de





**Dual Sensing Technology**  
unique Body-Sensing technology  
in combination with GloveCheck™



**Industry Leading Stopping Time**  
fastest stopping bandsaw available to the market

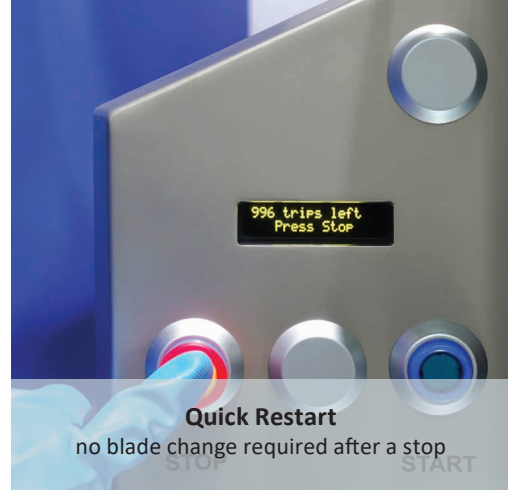

**Quick Restart**  
no blade change required after a stop

*The BladeStop's unique sensing and fast-stopping capabilities  
are the difference between having a near miss or an amputation.*

# “BladeStop just paid for itself”

- KILCOY General Manager



**High-end bandsaw for high-end products**  
designed for Quality, Hygiene and Safety



6-7.5 bar  
(85-110 psi)



380-400 VAC  
50/60 Hz



CE Certified



350-750kg  
(vary by model)



+1500 BladeStops  
supplied worldwide



IP 67-69k rated

**Contact your Scott representative for  
a complete list of BladeStop models  
and options available.**



BladeStop conforms to the European  
CE-Regulations according to the machinery  
directive 2006/42/CE.

*The type certification for machine types according to ANNEX  
IV required by the Machinery Directive Article 12 (3) b) was  
carried out by: DGUV Test, Prüf- und Zertifizierungsstelle,  
Nahrungsmittel und Verpackung, Fachbereich Nahrungsmittel  
Kenn-Nummer 055, Prüfberichtsnummer: NV 19357*